

**Crank Shade with Cables
Installation Instructions**

Tools Needed	Hardware Provided (per shade)	Hardware Needed
<p align="center"> Drill Measuring Tape Pencil 2" Level Plumb Line ¼" Masonry Drill Bit Hammer Linesmans Pliers Cable Cutters Phillips & Flat-Head Screw Driver 11/32 Socket or Open End Wrench 5/32 Allen Wrench </p>	<p align="center"> Brackets (2) Gear (1) Gear Bolts with Lock Washers (2) Turnbuckles (2) Tie Wire Drives (Cable Anchors) (2) Cable Sleeves (4) Cables (2 per shade) (2) Hand Brace (1) Shade Tube (1) </p>	<p align="center"> 5/16" X 4 ½ " Lag Screws or Appropriate (4 per shade) 3/8" Flat Washers or Appropriate (4 per shade) </p>

[*BELOW INSTRUCTION PICTURES GO FROM LEFT TO RIGHT]

1. Set-Up Shade For Mounting

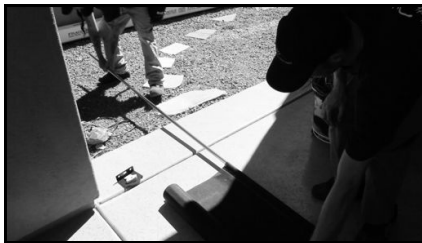

After parts are removed from packaging, temporarily remove bottom bar fabric on flat surface to make shade lighter to handle.

2. Install Brackets- Attach, Fix, Secure

Gear End Bracket



Snap-In Idler Bracket



Using appropriate lag bolts and washers, start at one end and attach bracket to mounting surface. Make sure bracket is level before securing screws. Repeat same process on opposite side with remaining bracket.

3. Hang Tube With Fabric - 2 Person Job



With your partner, hold tube with fabric up to brackets. Starting with your square pin end (operating side of shade), slide square pin into gear (#1). Once square pin is inserted into gear, take other end of tube (non-operating side of shade round pin) and snap it into corresponding slot of bracket and push down until it locks into place (#2). Using provided hand brace, roll shade down and insert bottom bar into bottom of fabric (#3).

4. Drill Holes For Cable Anchors



Use Plumb Line to hang from small hole in back of bracket (where pointing in picture) down to floor. Mark spot with pencil for cable anchor. Drill hole with $\frac{1}{4}$ " masonry drill bit.



Hammer in tie wire drives as far as they can go, making sure they are straight.

(You will repeat this process on other side)

5. Setting Up & Attaching Cables



Open turnbuckles by unscrewing each end until $\frac{1}{4}$ " thread remains inside turnbuckle housing.
Attach hook end of turnbuckle to tie wire drive.



At the top of the cable, you will find a small cable clamp that is already attached (this will eventually attach to your bracket and your cable will go through it). With a flat head screw driver, unscrew front setscrew and remove tension device from cable. With tension device now by itself, remove remaining screw and nut. If you can't unscrew by hand, use a Phillips head screwdriver for front screw and an $11/32$ socket or open-end wrench for back nut.



Attach clamp to crank bracket with screw you removed earlier. Secure with nut on back. With nut secure on back, use Phillips screwdriver to tighten device to bracket with front screw.



Slip cable through eyelet of bottom rail. Bring cable up and through tension device. Using flathead screwdriver, secure cable to tension device. Cut off excess cable at top.

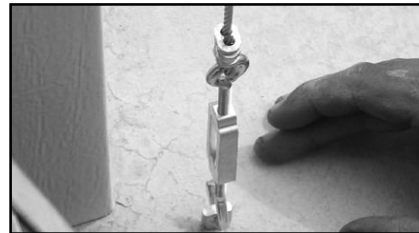

Close turnbuckles to add tension to cables. (Hold top of buckle and turn clockwise).

Repeat whole process on other side.

6. Safety Wire Turnbuckles

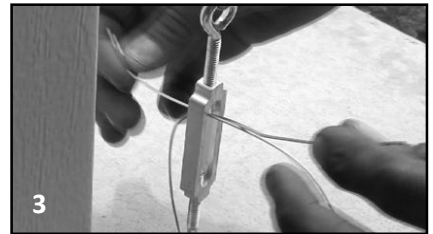
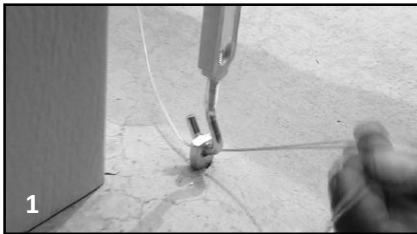

Using left over cable, unravel two strands of wire about 10" in length. Weave strands of wire through tie wire, turnbuckle and then cable loop. Use pliers to twist wire tight. Cut off excess. This prevents the turnbuckle from twisting and loosening the cables. You will repeat this on the other side.

7. Operate Shade



Slide hook end of hand brace into eyelet of gear on shade. Shade rolls up and down on cable guides.

You're done! Enjoy!